



## **Surgical Technique**



# Summary

|  |    |
|--|----|
| Concept and range .....                          | 5  |
| Surgical technique overview .....                | 8  |
| Step 1 - Pre-operative planning .....            | 10 |
| Step 2 - Acetabulum reaming.....                 | 11 |
| Step 3 - Reaming control.....                    | 12 |
| Step 4 - Holding the cup .....                   | 14 |
| Step 5 - Final cup impaction.....                | 15 |
| Step 6 - Trials with trial liner (optional)..... | 16 |
| Step 7 - Head impaction in the liner .....       | 17 |
| Step 8 - Final implant reduction .....           | 18 |
| Instrumentation.....                             | 20 |
| Annex A.....                                     | 24 |
| Annex B.....                                     | 25 |
| Annex C.....                                     | 26 |
| Annex D.....                                     | 28 |



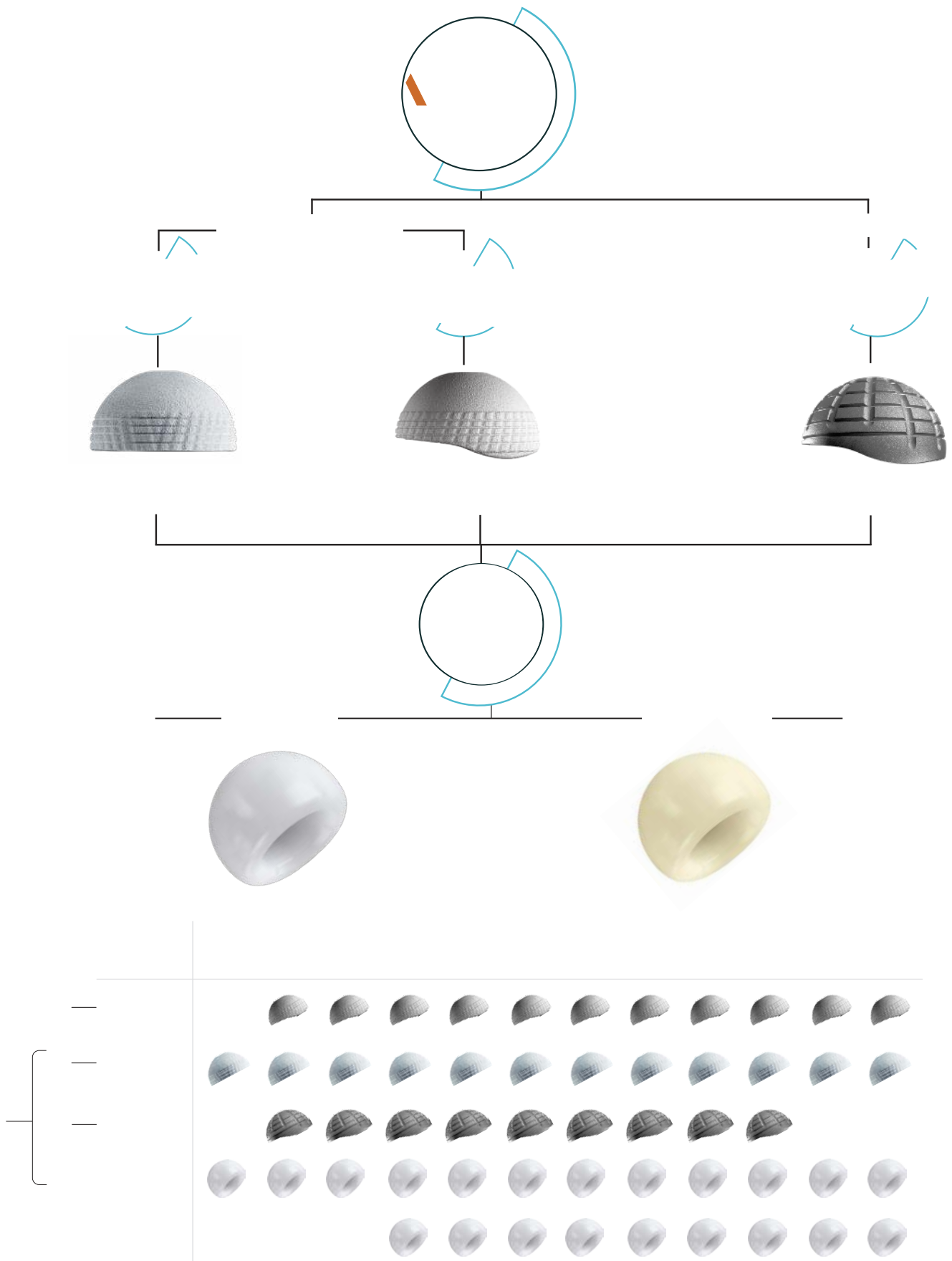

---

Cylindro-spherical cementless cup with Ti + HA coating:

- 3 mm cylindrical overhang
- 1 mm equatorial press-fit at diameter
- Inverted chevron grooves
- Concentric parallel grooves

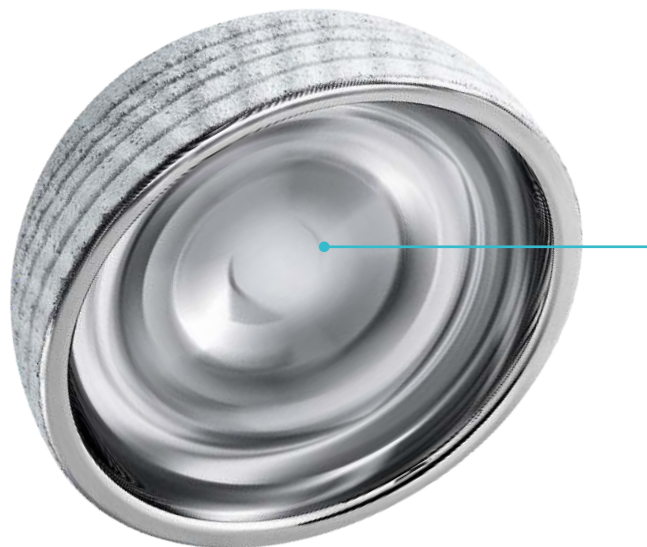
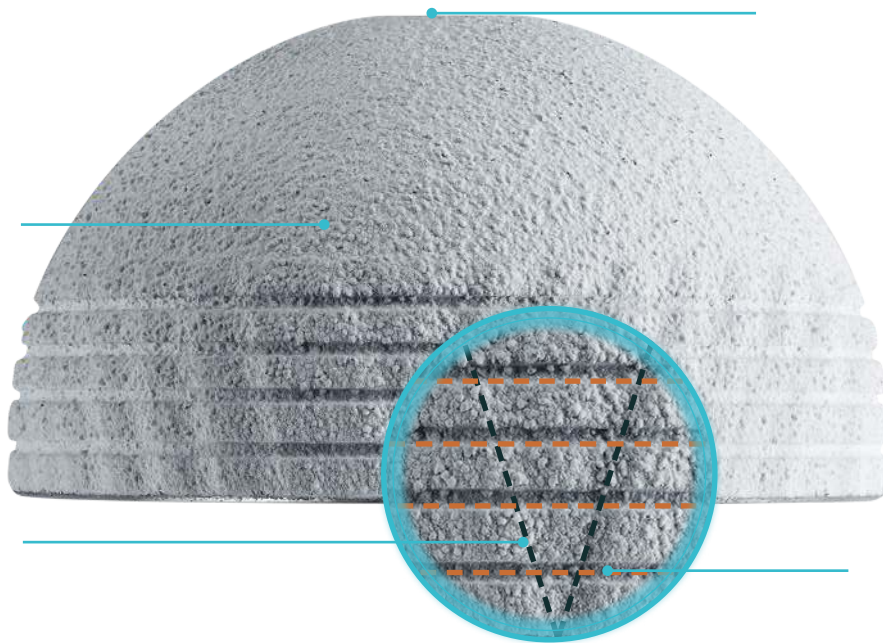

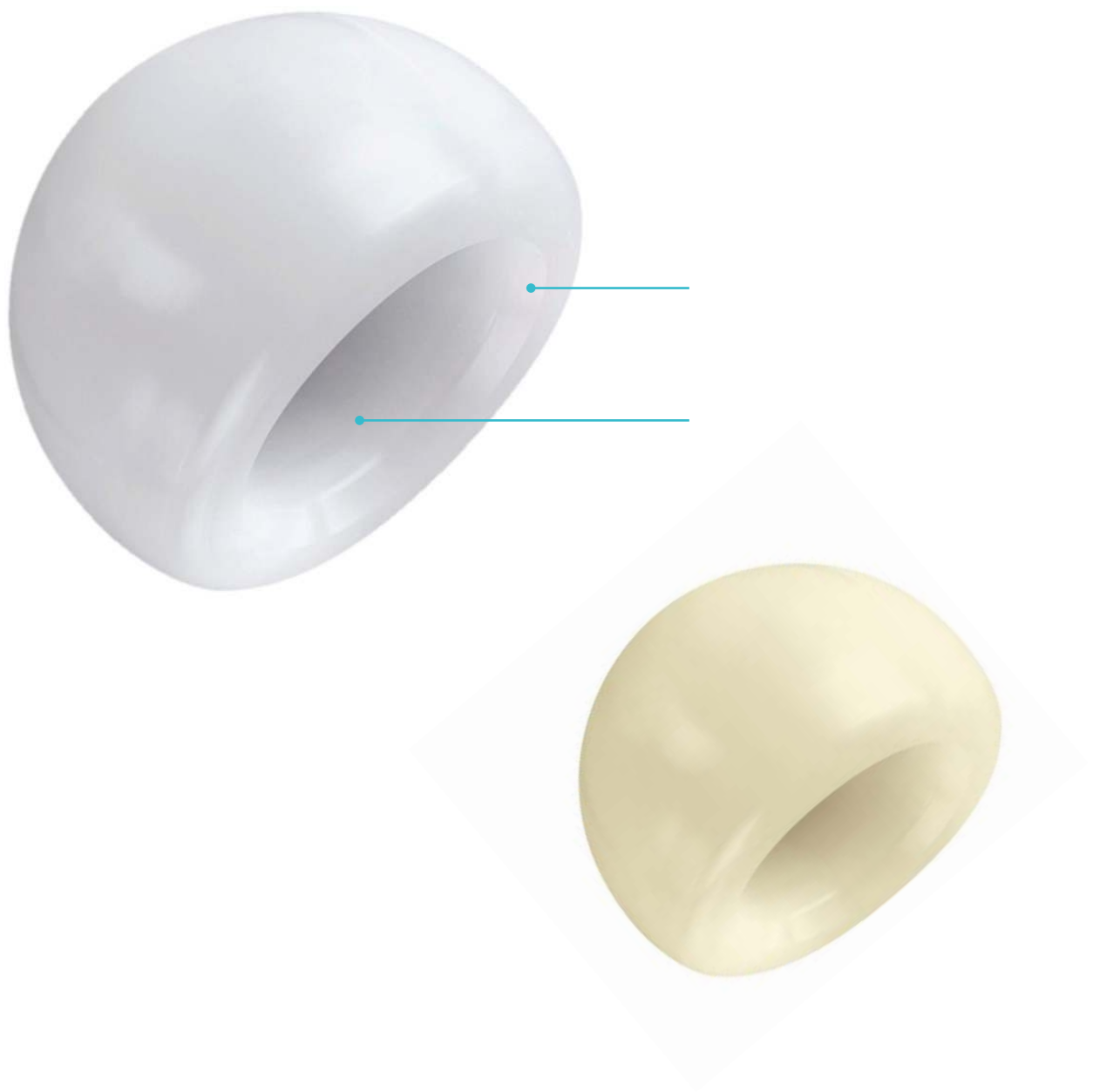

1



2



3



4





5



6

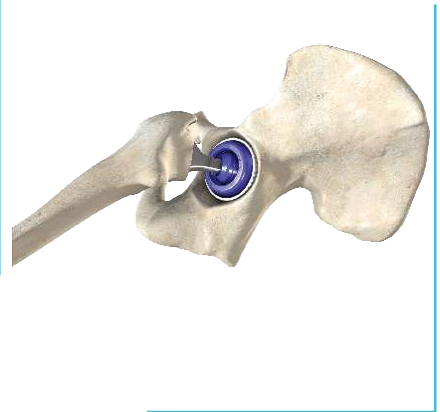

7

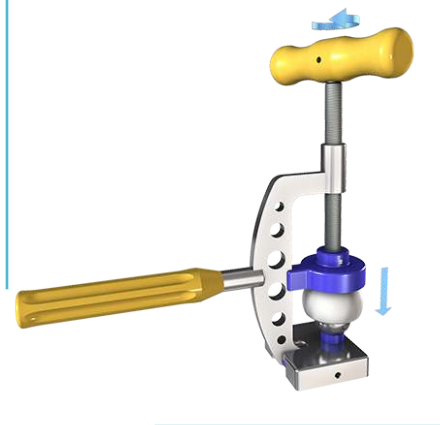

8



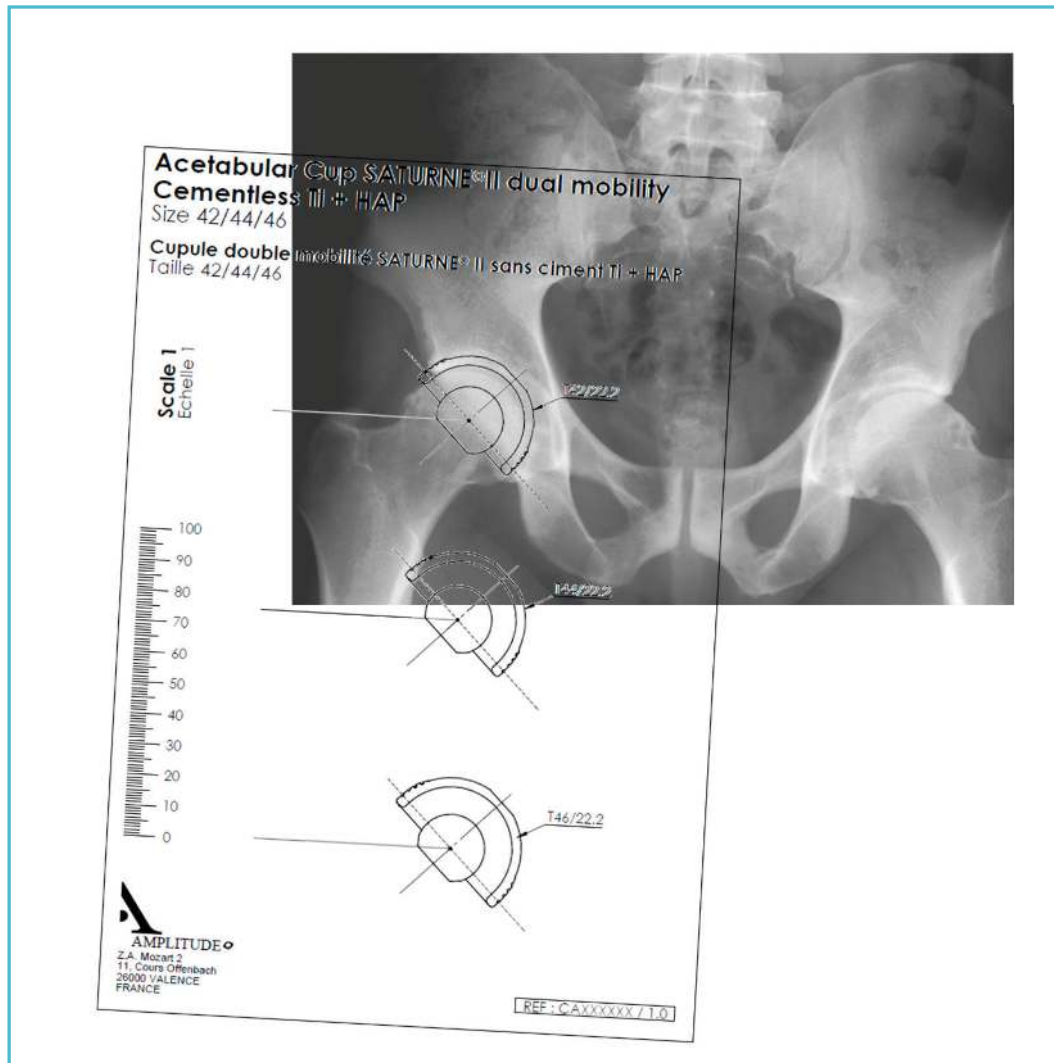





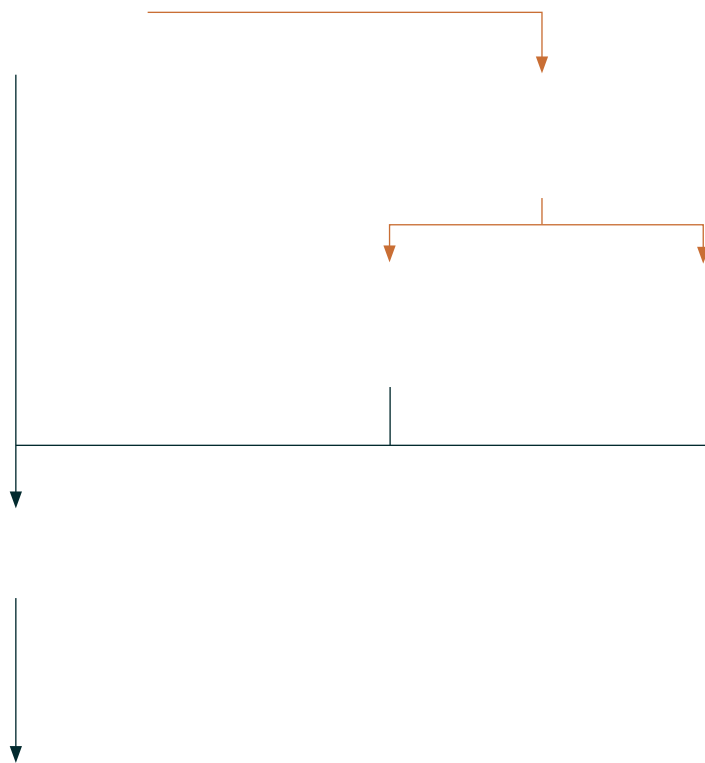





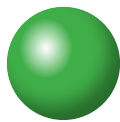
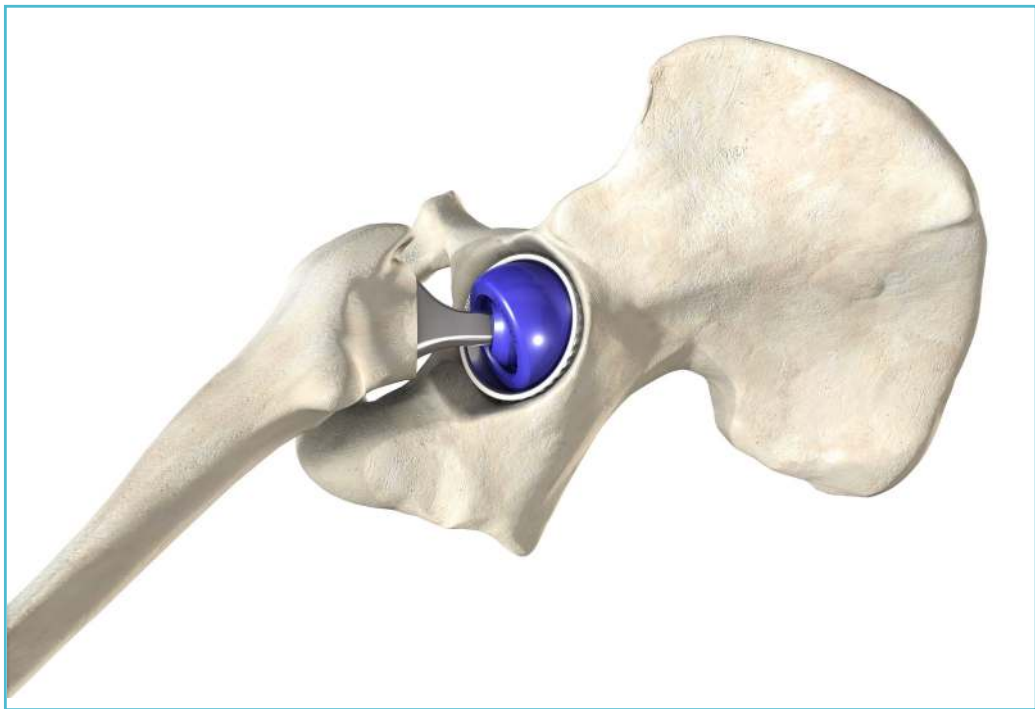

Ø22.2mm

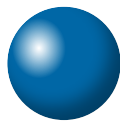

Ø28mm

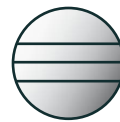
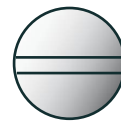
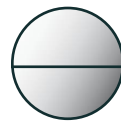



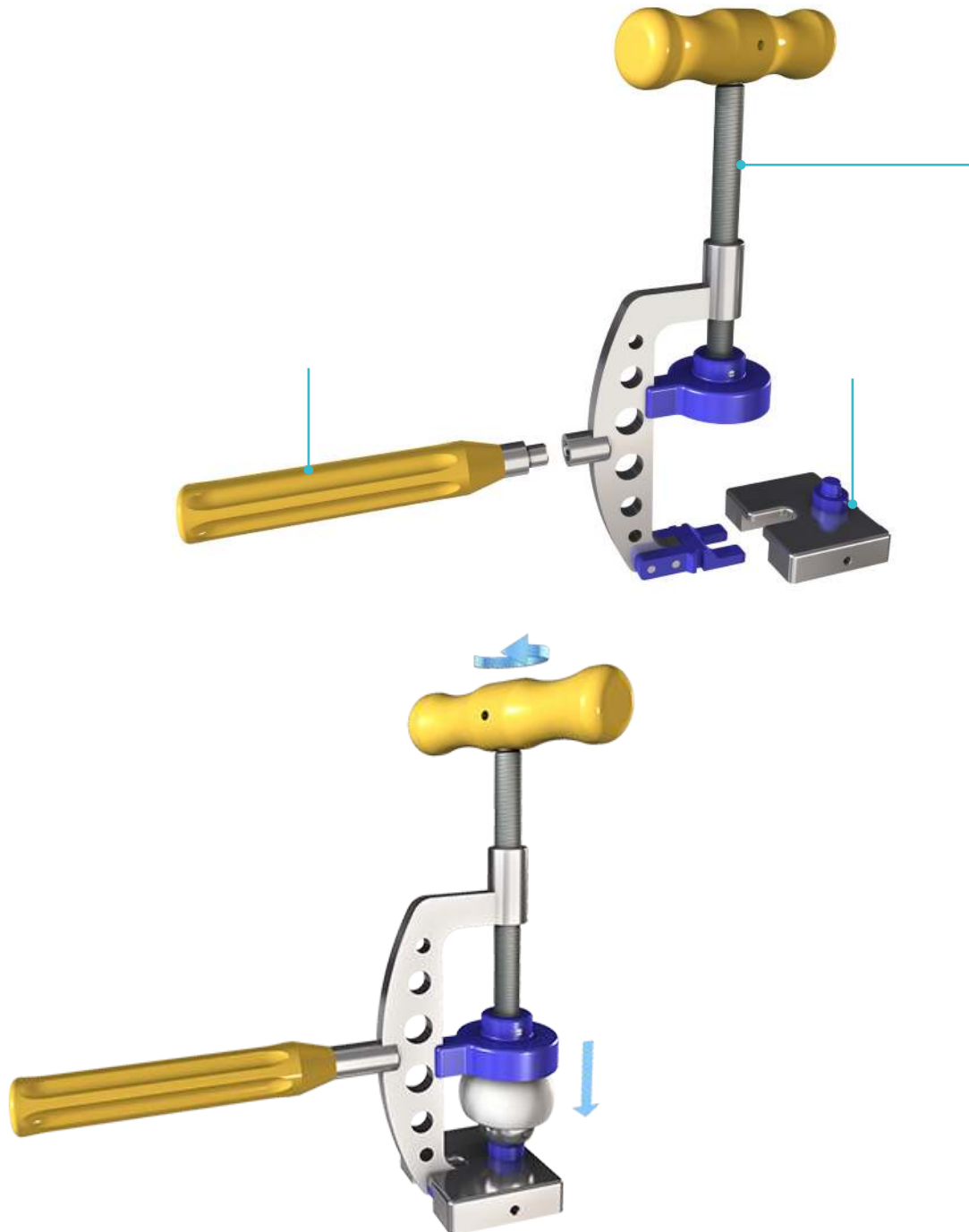

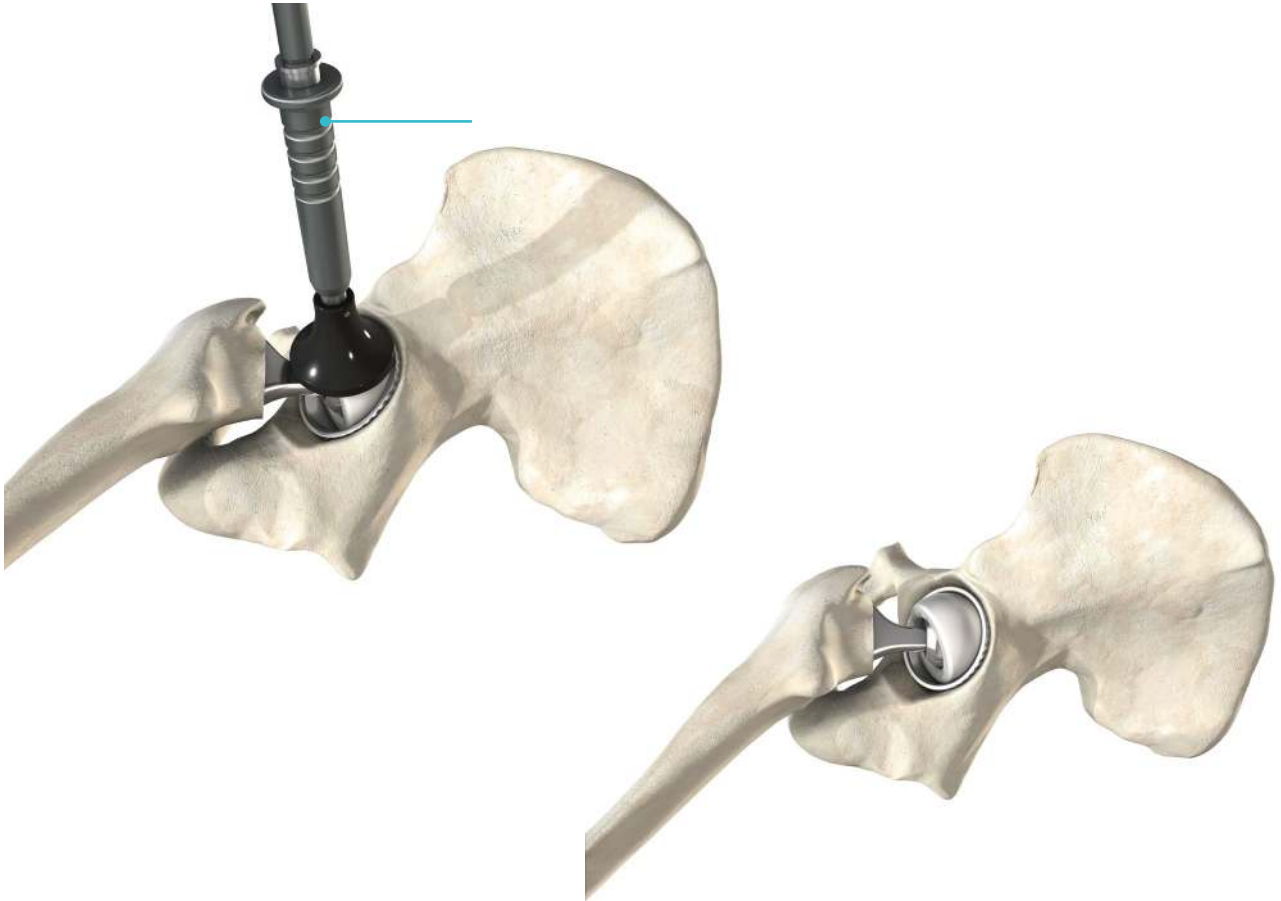

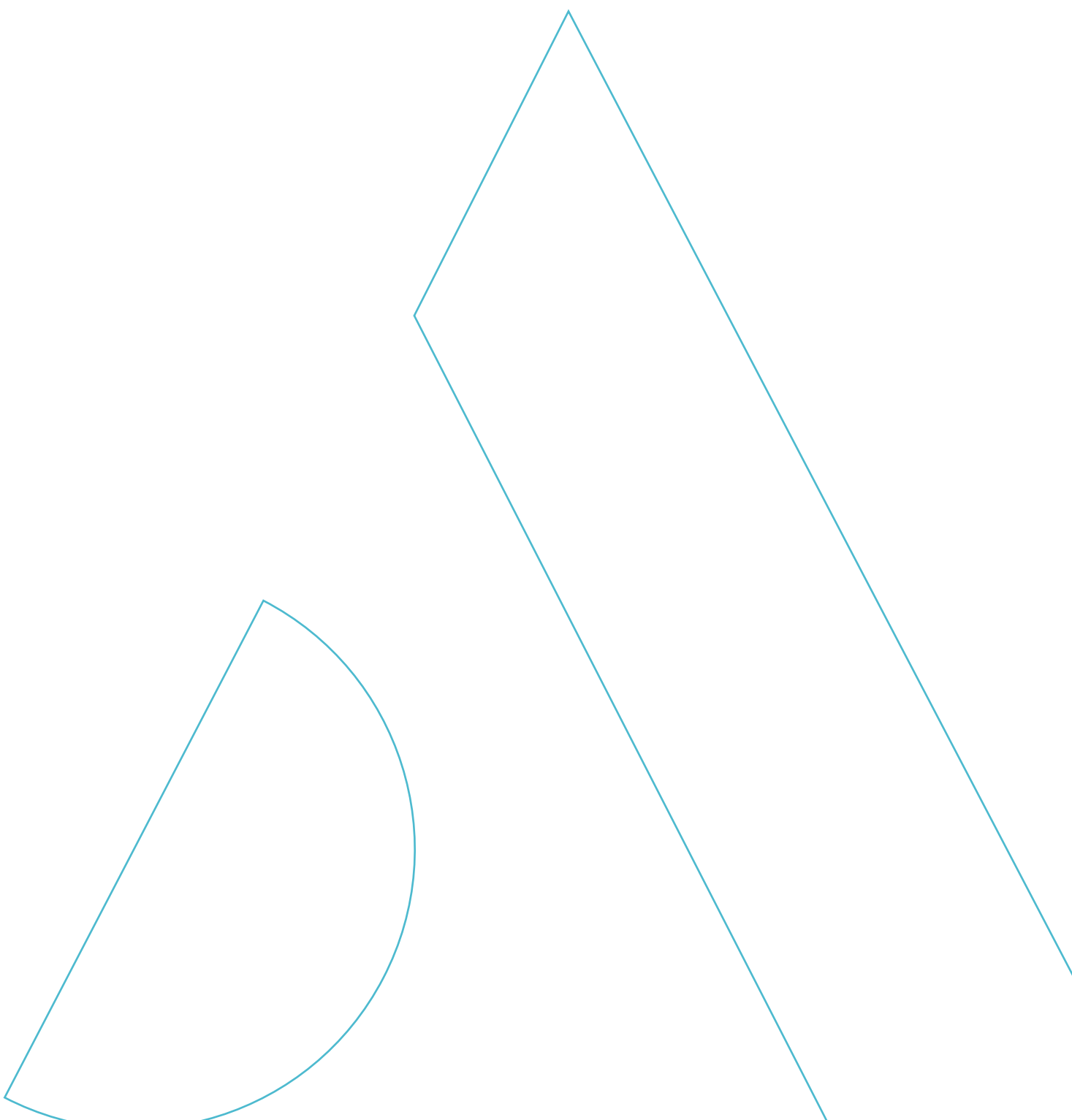

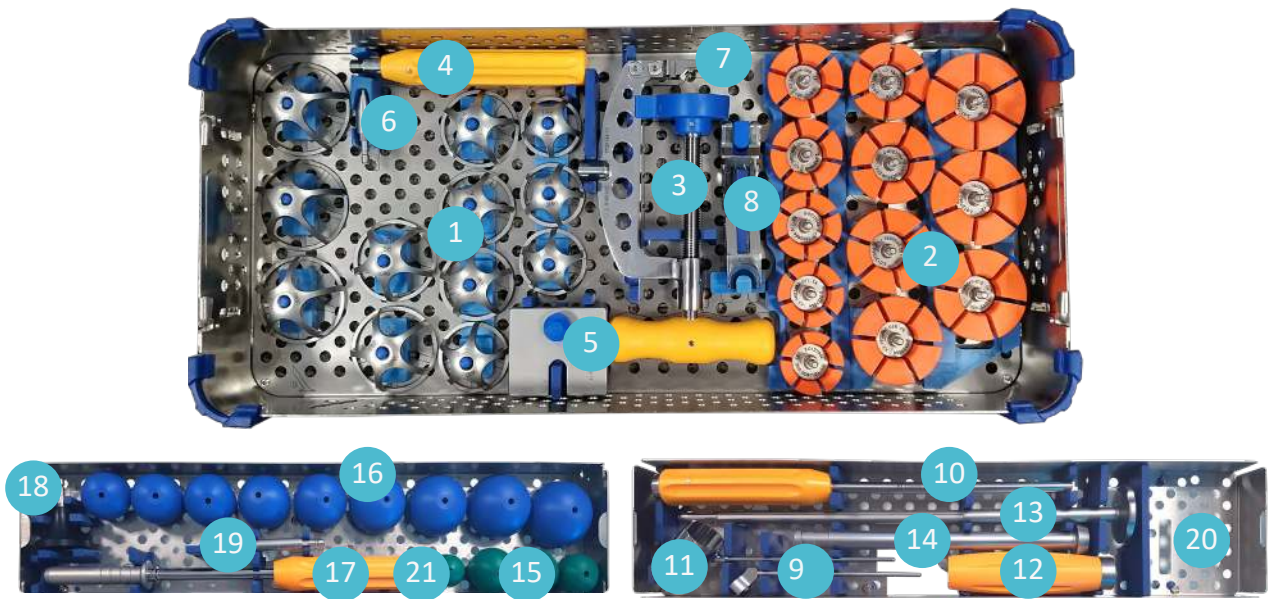

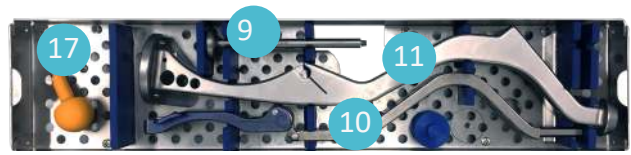
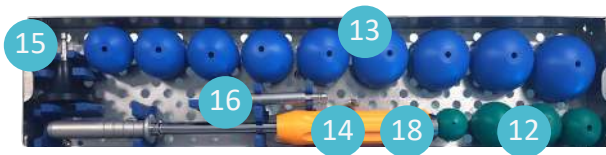
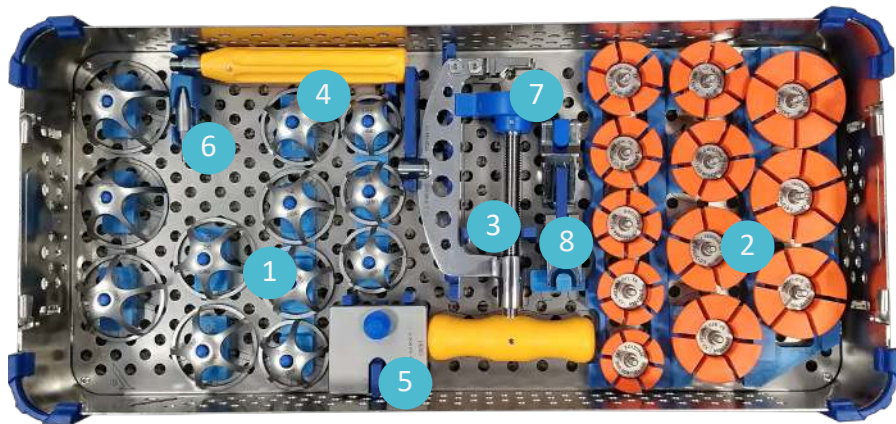

# Instrumentation

## Acetabular reamers set

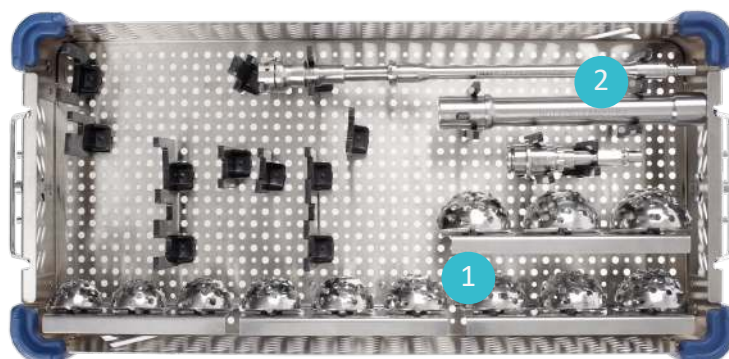

| Rep | Designation   | Reference                 | Qty    |
|-----|---|---------------------------|--------|
| 1   | Acetabular reamer $\varnothing 42$ to $\varnothing 64$                                      | 2-0192942<br>to 2-0192964 | 1 each |
| 2   | Metallic Reamer handle - Straight<br>+ Connection Tip reamer Handle - Power Tool - Large AO | 2-0131001<br>+ 2-0131003  | 1 each |

## Acetabular reamers set - odd sizes



| Rep | Designation  | Reference                 | Qty    |
|-----|--|---------------------------|--------|
| 1   | Acetabular reamer $\varnothing 41$ to $\varnothing 65$ | 2-0192941<br>to 2-0192965 | 1 each |
| 2   | Straight Reamer Handle - AO coupling                   | T17780*                   | 1      |

*\*optional if the tray of even sizes reamers has already been provided.*



| Description                          | Reference |
|--------------------------------------|-----------|
| IMA reamer handle - Metallic<br>– AO | 50244501  |



| Description   | Reference               |
|---|-------------------------|
| Metallic Reamer handle - Offset<br>+ Connecting Shaft Assembly - Large AO | 2-0131002<br>+2-0131005 |

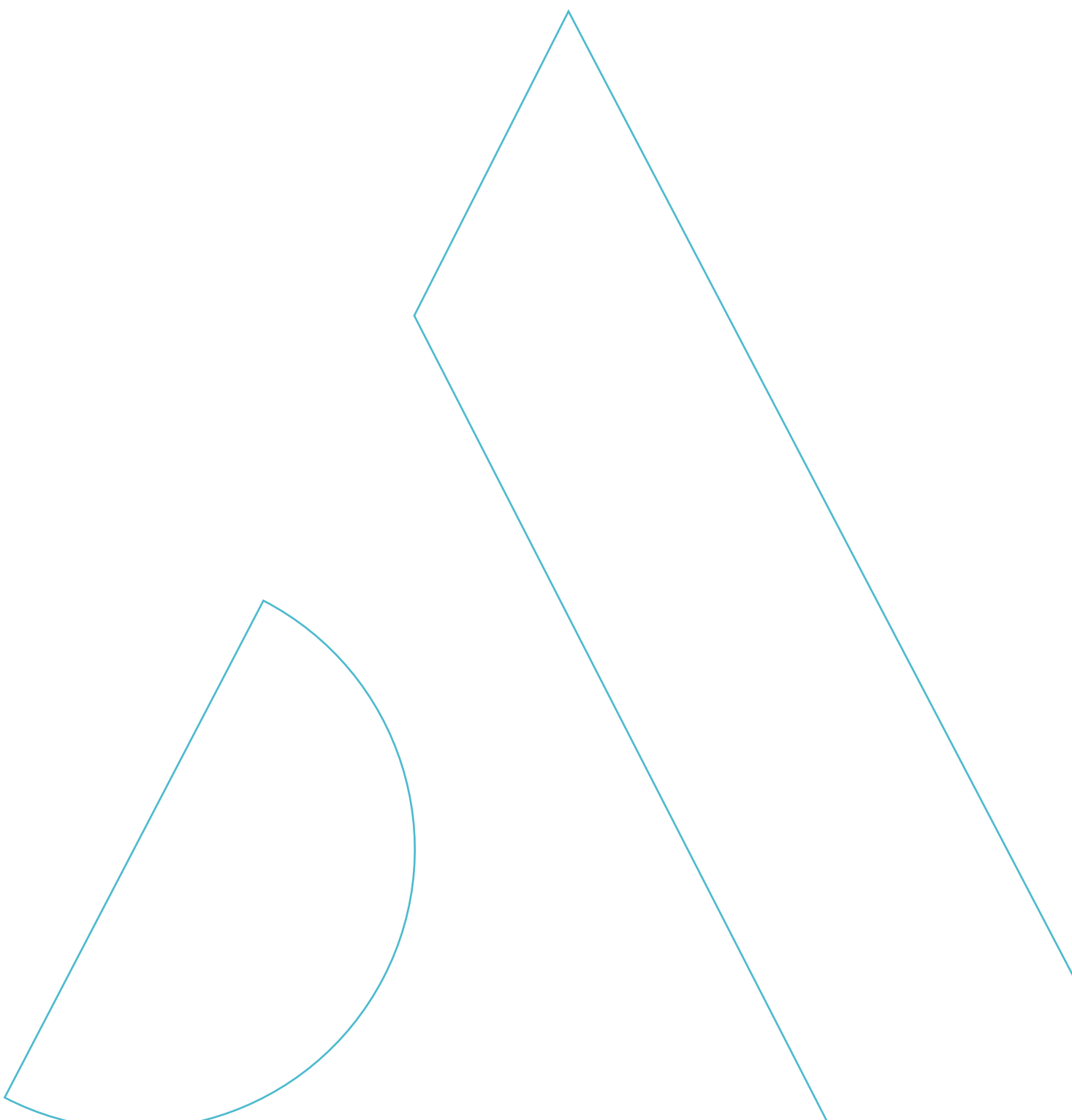

---

# Appendix A

## Rod assembly on the curved impactor

The curved impactor handle has two components:

• The rod

• The impactor handle body



To assemble those two elements:

- 1 Slide the rod into the opening on the impactor handle;
- 2 Place the end of the rod in the opening at the end of the impactor handle;
- 3 Set the oval projection on the rod's blue lever in the oblong hole on the impactor handle.



The impactor handle is now ready for use in the following positions:

- **Rod insertion position;**
- **Open position,** used to assemble the expandable impactor tip (push the part of the rod identified by the orange arrow of the illustration to ease this positioning);
- **Locked position,** used to insert the trial cup (if the handle is used with the rod already assembled for trials) and the final cup.

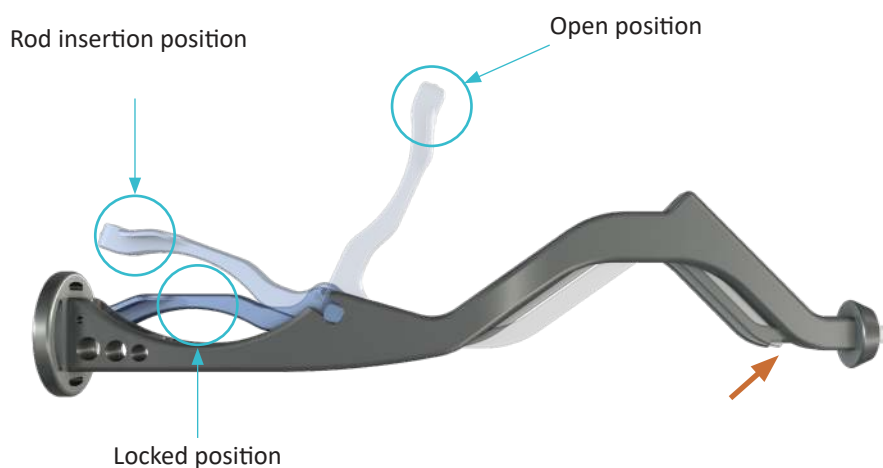



# Appendix B

## Straight impactor assembly

The straight impactor handle has three components:



To assemble these elements:

- 1 Assemble the handle and tube;



- 2 Slide the threaded rod into the open end of the handle while maintaining previous assembly.



**Warning:** a pin in the tube engages the groove in the threaded rod. This enables only one position of the threaded rod.

- 3 Turn the yellow handle completely to complete the assembly.



---

# Appendix C

## Straight reamer handle assembly

The acetabular reamer handle is composed of three elements:

▸ The rod



▸ The sleeve



▸ The connection tip to power tool



Instructions for the assembly of the three parts:

- 1 The sleeve tip with the oblong hole should be oriented towards the power tool. If assembled in the wrong position, it will be impossible to join the connector to the power tool at a later stage. It is therefore crucial that this hole is on the same side as the power tool connection tip. The oblong hole is designed to accommodate the navigation tip in the case of navigated surgery.

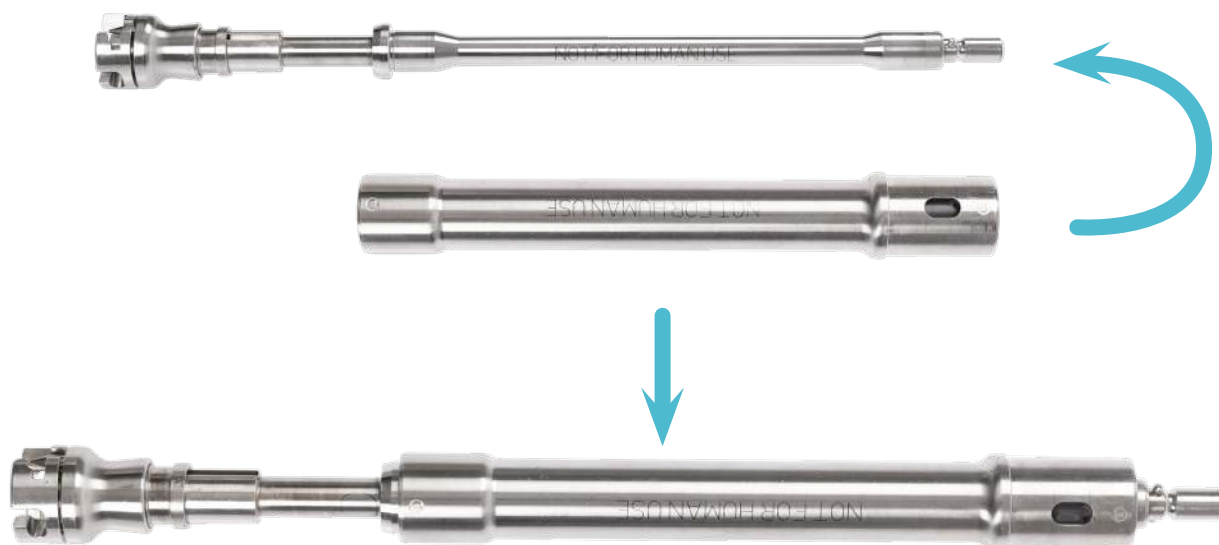

# Appendix C

## Straight reamer handle assembly

### 2 Assembly of the connection tip to the power tool:

Pull out the small ring (a) of the connection tip to the motor and position it on the previous assembly, turning it through a quarter-turn and then releasing the ring. Note that the instrument set is made up of either the Large AO option **(2-0131003)** or the Zimmer Hall option **(2-0131004)**.

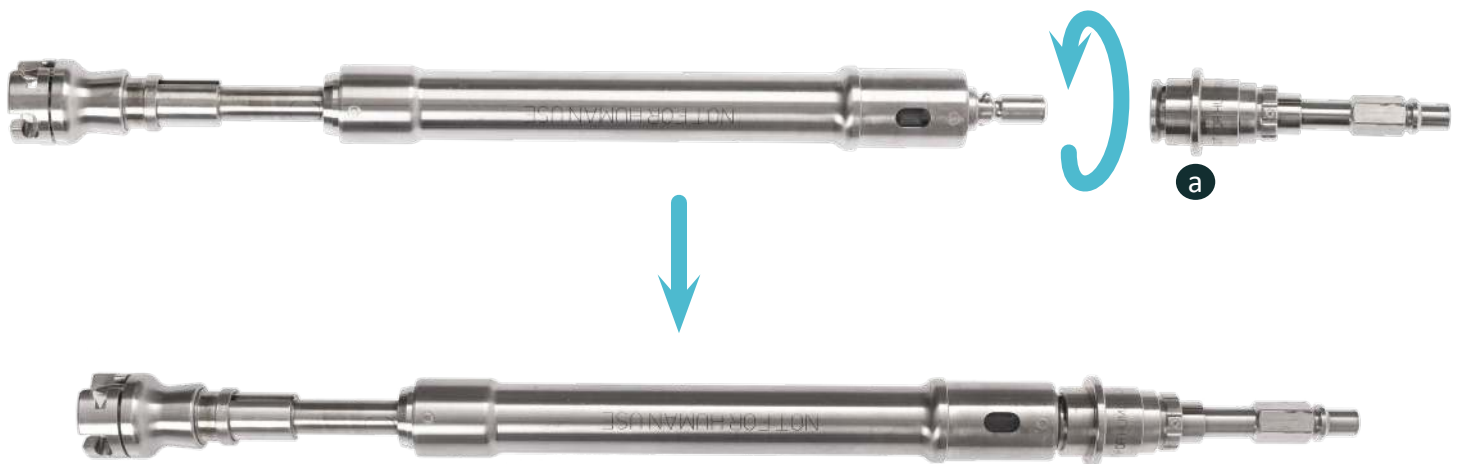

Check that the sleeve rotates freely around the rod.

For disassembly, follow the steps in reverse order.

---

▶ The power tool linking rod  
(Large AO or Zimmer-Hall)

▶ The handle

▶ The reamer locking system

▶ The sleeve and the cover



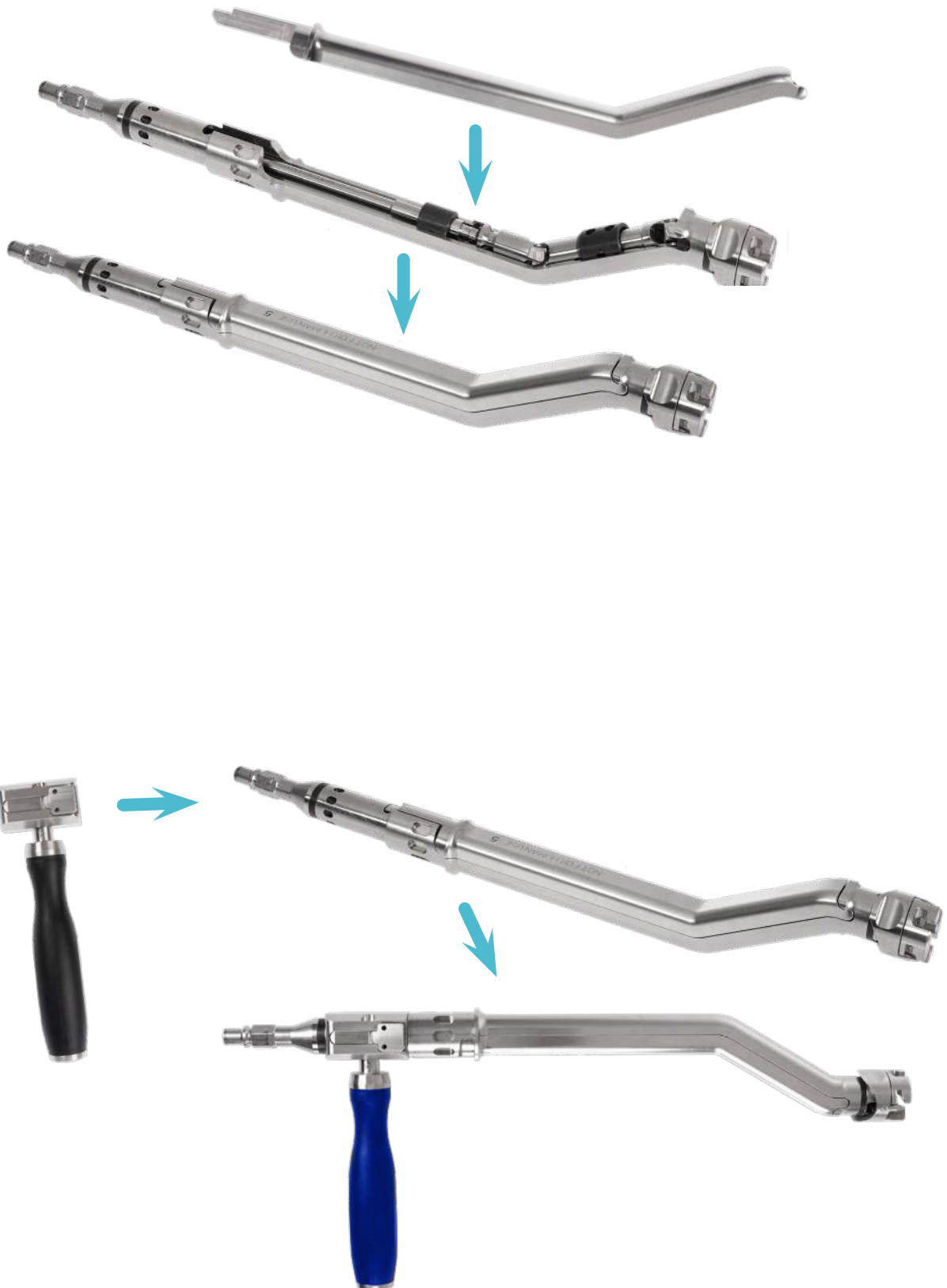

[illegible]





*Products availability may vary depending on countries. Please check availability with your local representative.*

**Service Clients – France :**

Porte du Grand Lyon,  
01700 Neyron – France  
Tél. : **+33 (0)4 37 85 19 19**  
Fax : +33 (0)4 37 85 19 18  
E-mail : [amplitude@amplitude-ortho.com](mailto:amplitude@amplitude-ortho.com)

**Customer Service – Export :**

11, cours Jacques Offenbach,  
ZA Mozart 2,  
26000 Valence – France  
Tél. : **+33 (0)4 75 41 87 41**  
Fax : +33 (0)4 75 41 87 42

[www.amplitude-ortho.com](http://www.amplitude-ortho.com)



<https://eifu.amplitude-ortho.com>